

Axiom Installation Guide

SD14 - Paramount



**Surrounded
by Experts.**

TM

Index

Disclaimer_____	3
SD14-01 Assembly_____	4
SD14-01 Slab Edge Connection_____	5
SD14-02 Assembly_____	6
SD14-02 Slab Edge Connection_____	7
SD14-03 Assembly_____	8
SD14-03 Slab Edge Connection_____	9
SD14-04 Assembly_____	10
SD14-04 Slab Edge Connection_____	11
SD14-05 Assembly_____	12
SD14-05 Slab Edge Connection_____	13
SD14-06 Assembly_____	14
SD14-06 Slab Edge Connection_____	15
SD14-11 Assembly_____	16
SD14-11 Slab Edge Connection_____	17
SD14-12 Assembly_____	18
SD14-12 Slab Edge Connection_____	19
Handrail bracket connection_____	20

Disclaimer and Important Notes

- (a) Except as provided in the Terms, all express and implied warranties, guarantees and conditions under statute or general law as to:
 - (i) merchantability, description, quality, suitability or fitness of the Goods or Services for any purpose; or
 - (ii) design, assembly, installation, materials, workmanship or otherwise,are expressly excluded.

- (b) Axiom is not liable for physical or financial injury, loss or damage or consequential loss or damage of any kind arising out of:
 - (i) the supply, layout, assembly, installation or operation of the Goods or Services; or
 - (ii) Axiom's negligence or other act or omission.

- (c) In addition to, and without in any way limiting, paragraphs (a) and (b) above, and notwithstanding that Axiom may provide engineering drawings, which (if it does) must be read in conjunction with Axiom's installation instructions:
 - (i) it is the Customer's responsibility to comply with all Australian laws, all Standards (including but not limited to AS1288 and AS1170.1), the Building Code and the requirements of all relevant authorities;
 - (ii) the Customer must ensure that any existing structures or substrates to which the Goods are being affixed to are verified by a project engineer as structurally suitable to safely support the Goods or any other items being affixed to the structures or substrates; and
 - (iii) the Customer must fully insert and tighten all fasteners (including but not limited to baseplate screws) before installation of the Goods.

Paramount (SD14-01) Assembly

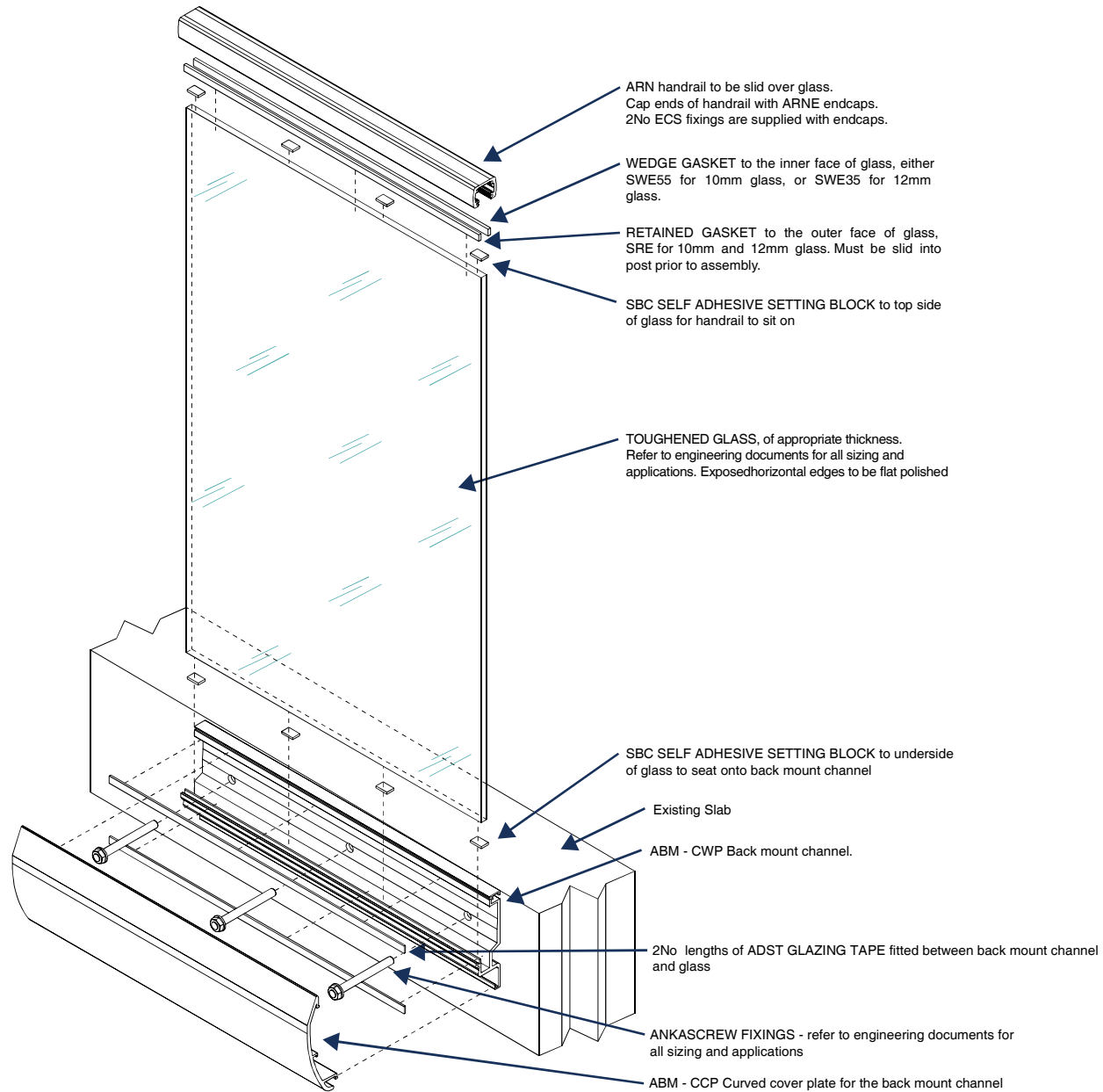

Paramount (SD14-01) Slab Edge Connection

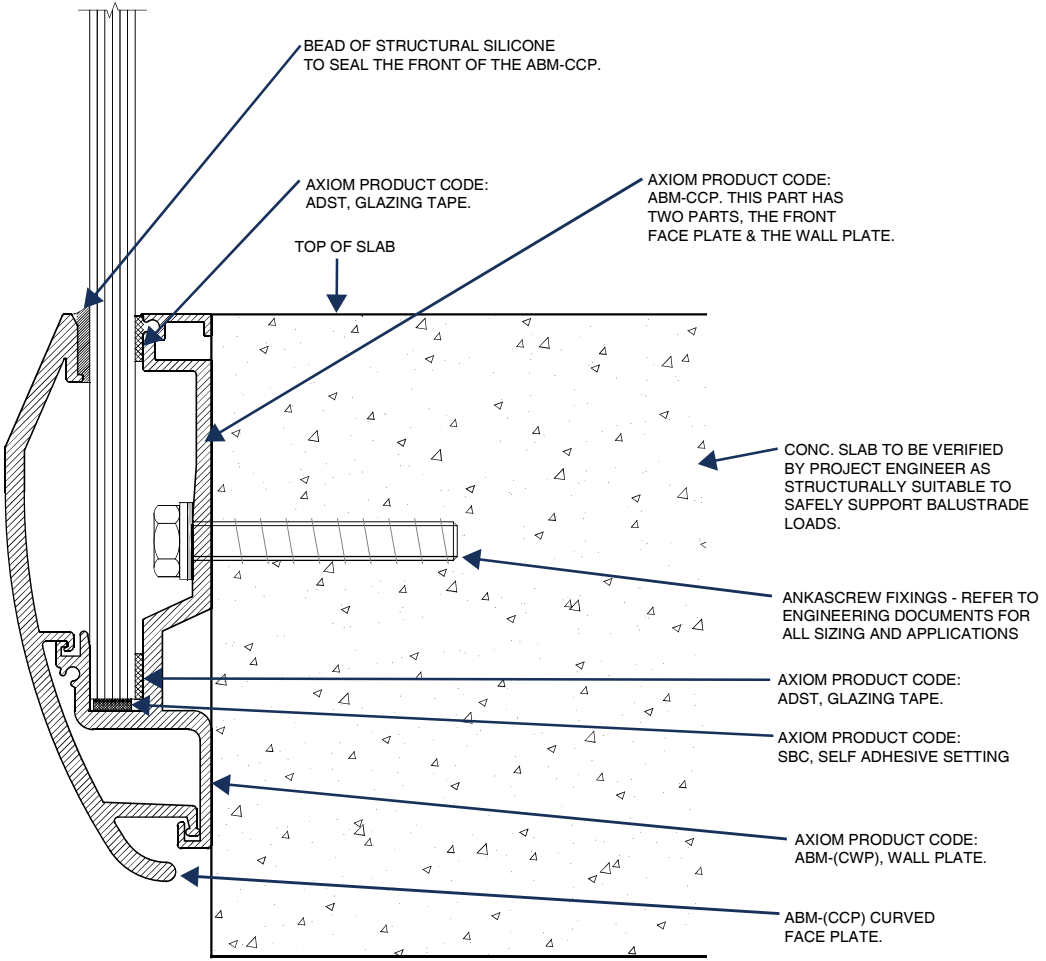

Paramount (SD14-02) Assembly

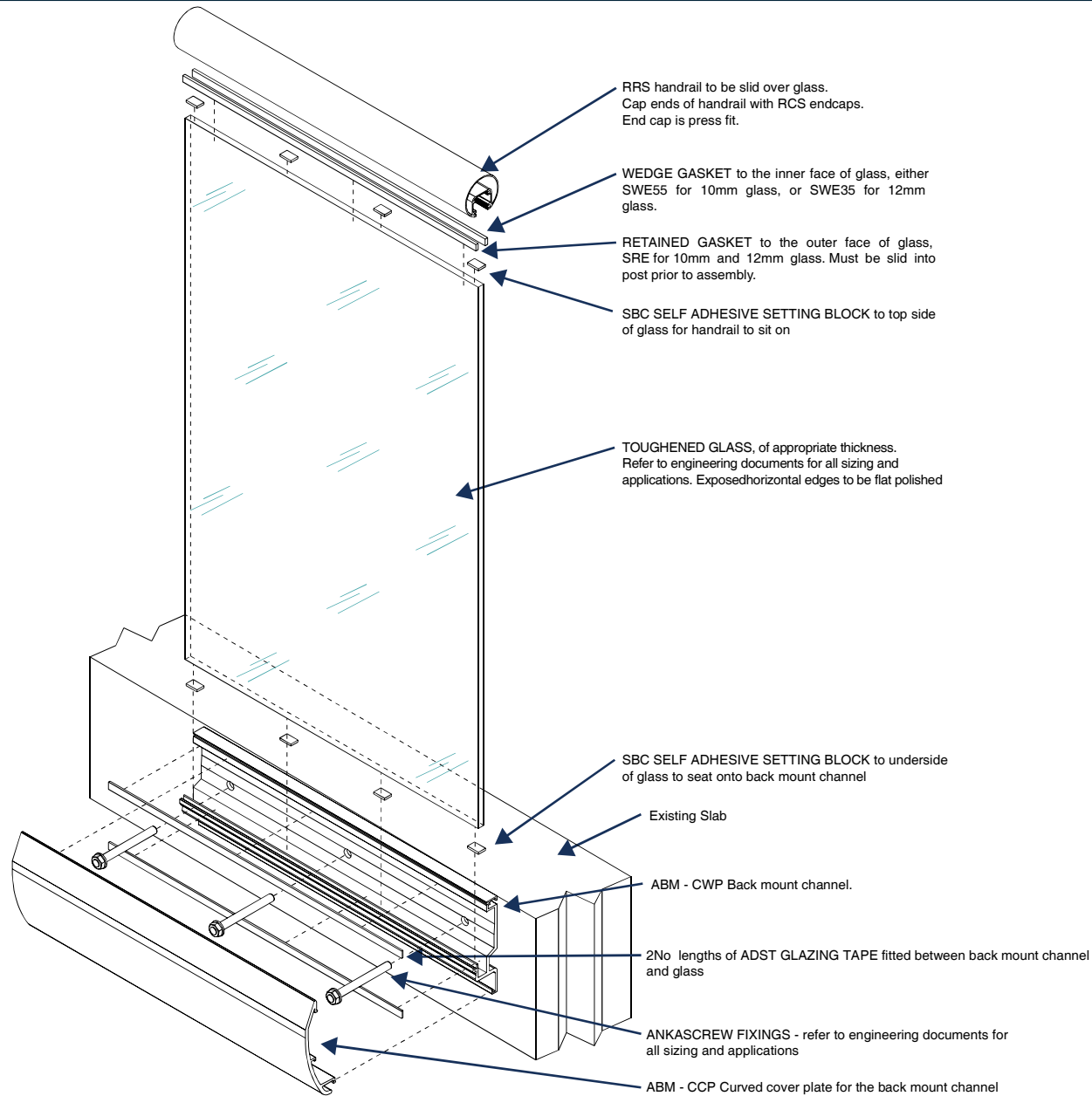

Paramount (SD14-02) Slab Edge Connection

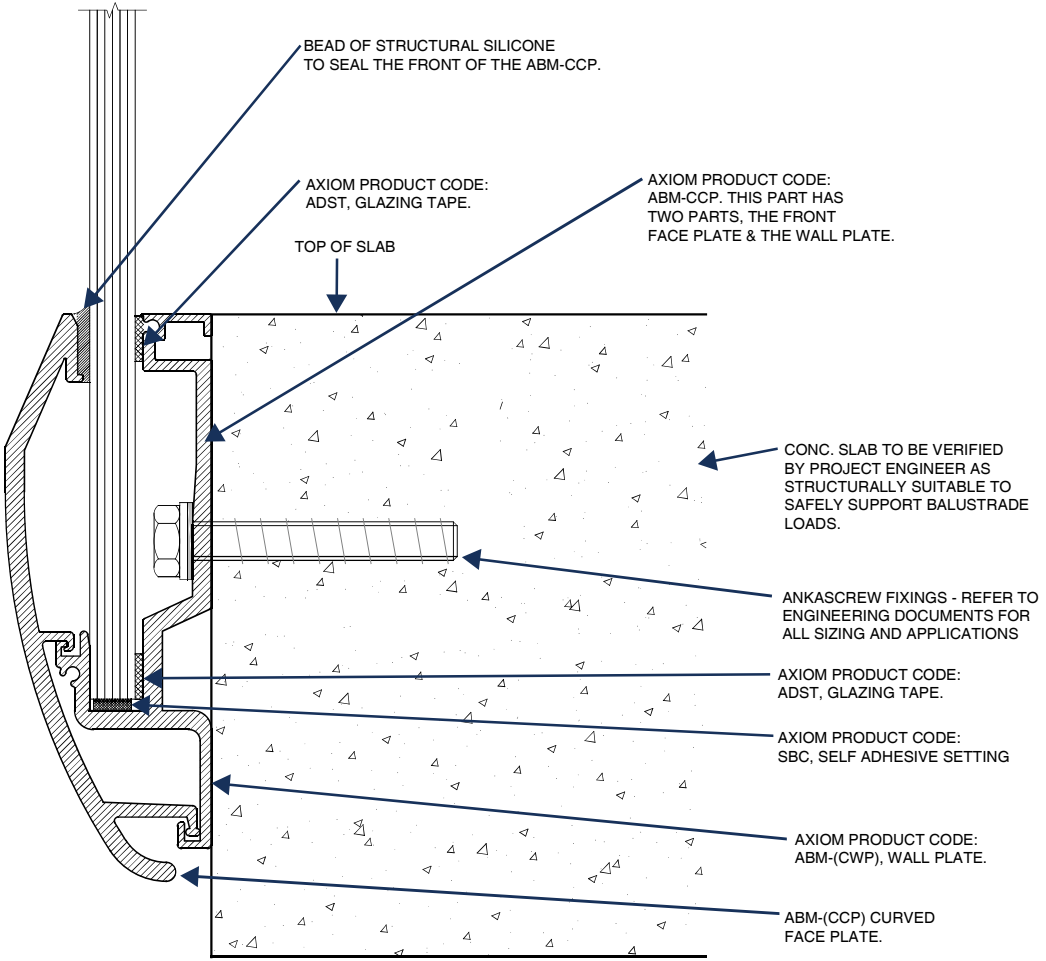

Paramount (SD14-03) Assembly

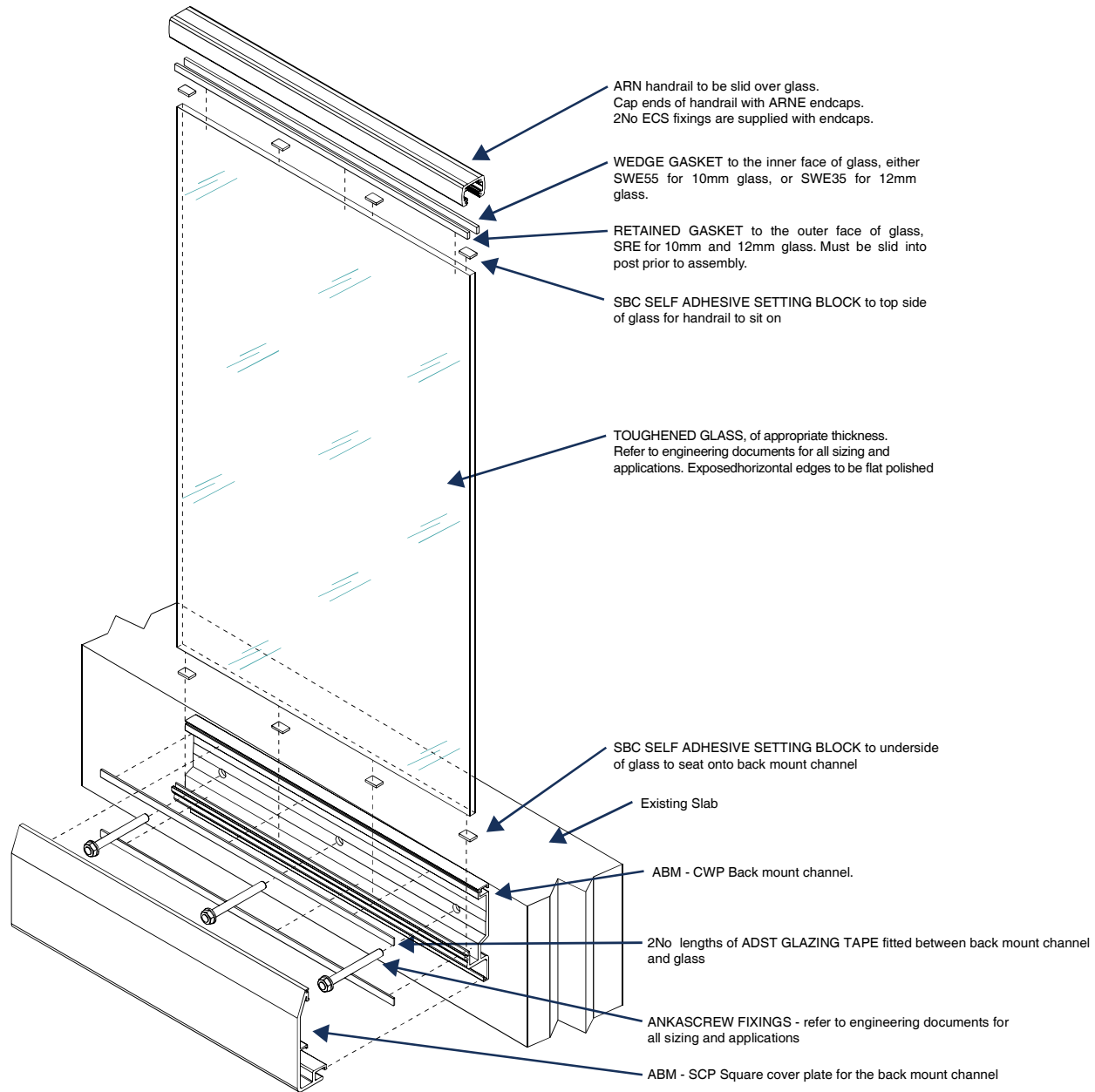

Paramount (SD14-03) Slab Edge Connection

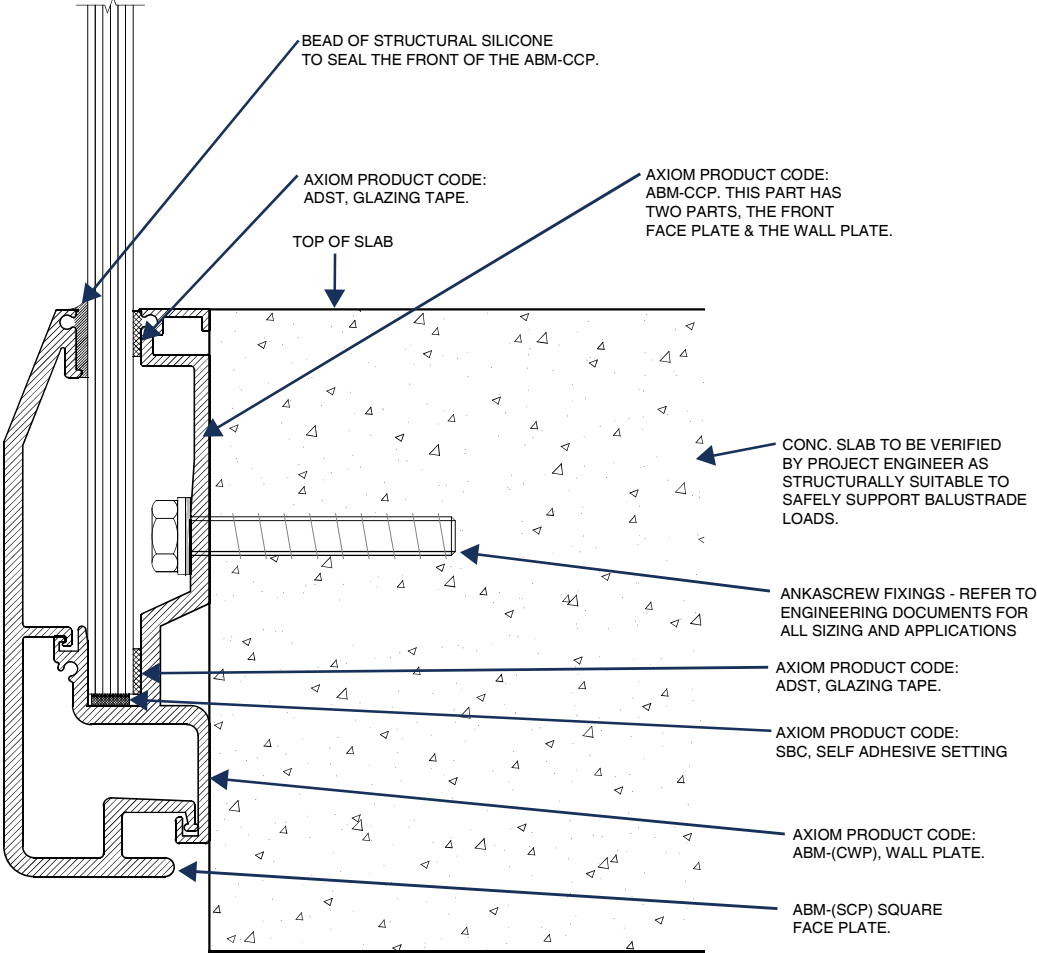

Paramount (SD14-04) Assembly

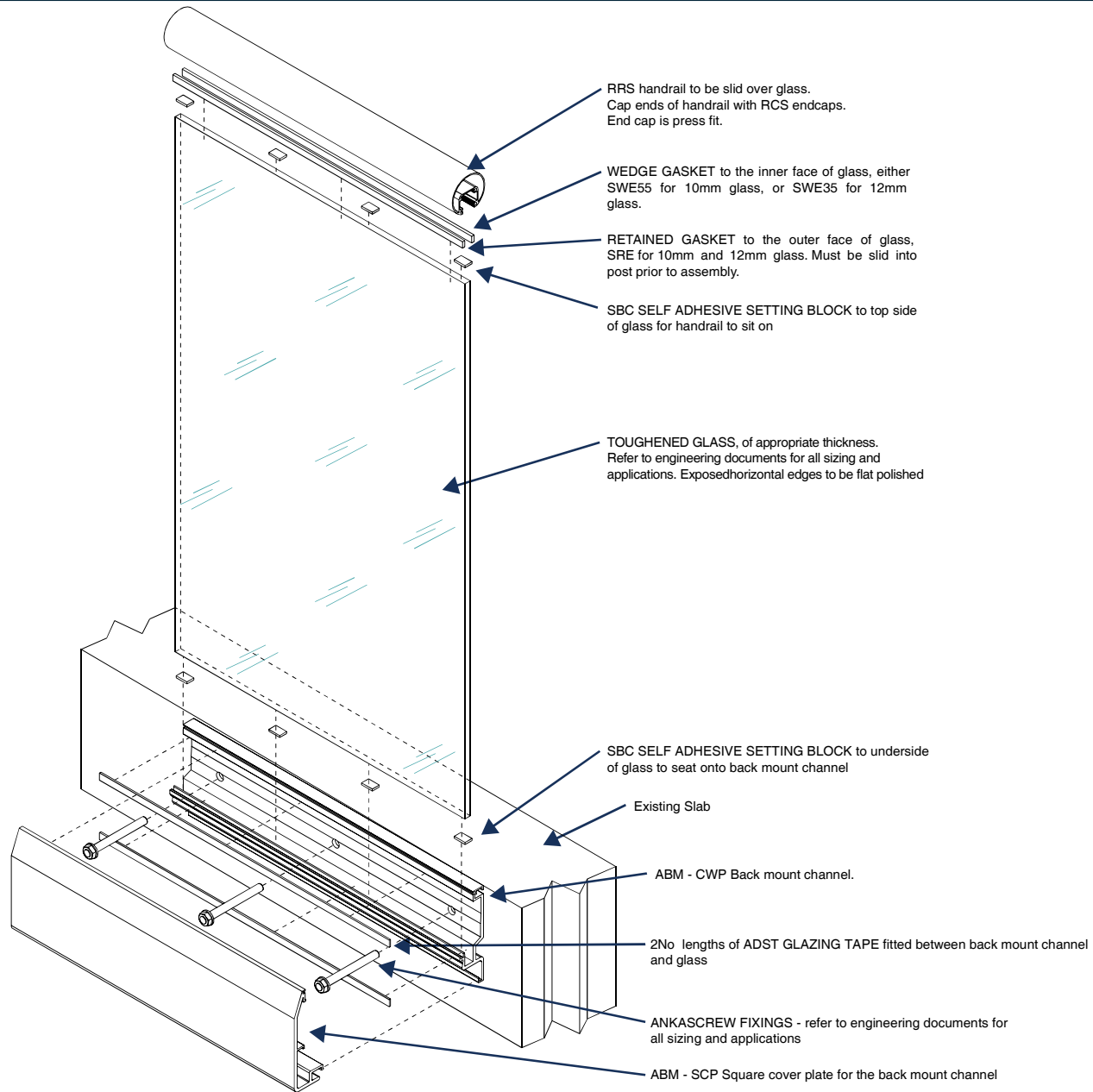

Paramount (SD14-04) Slab Edge Connection

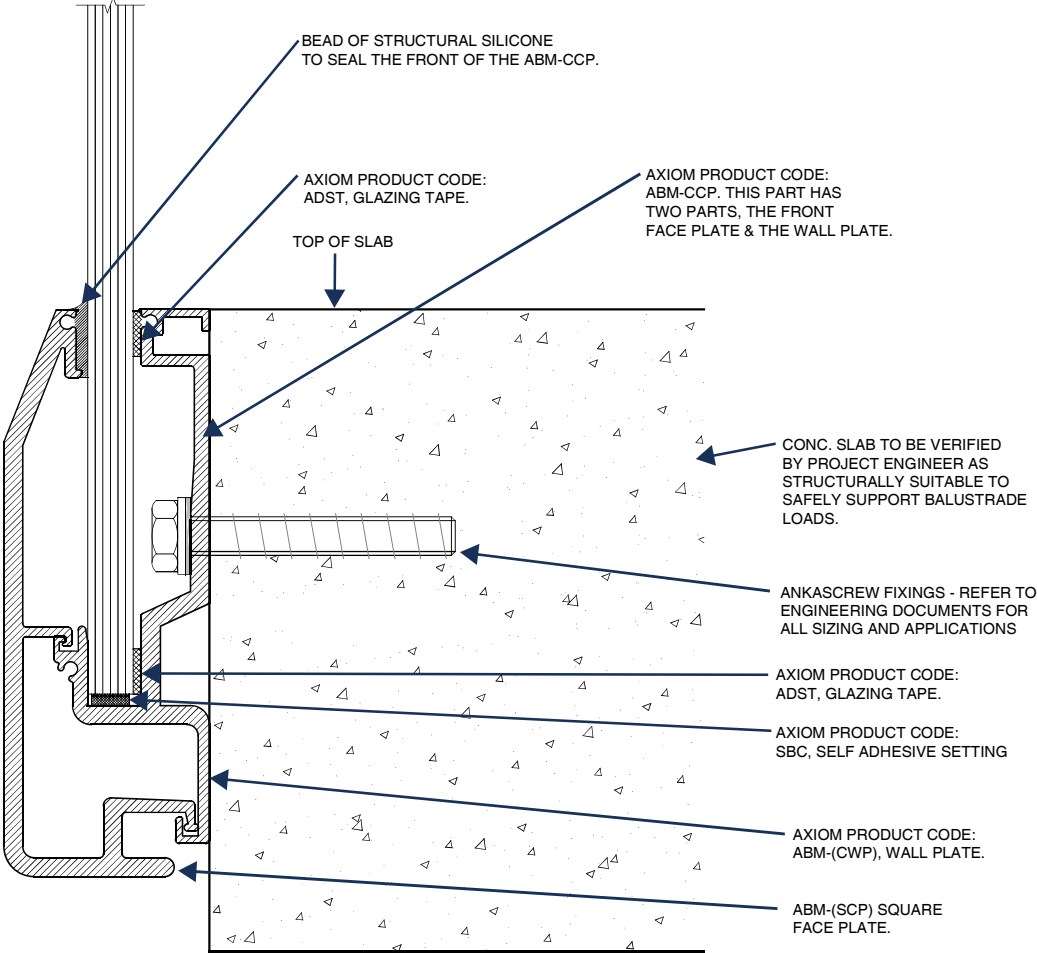

Paramount (SD14-05) Assembly

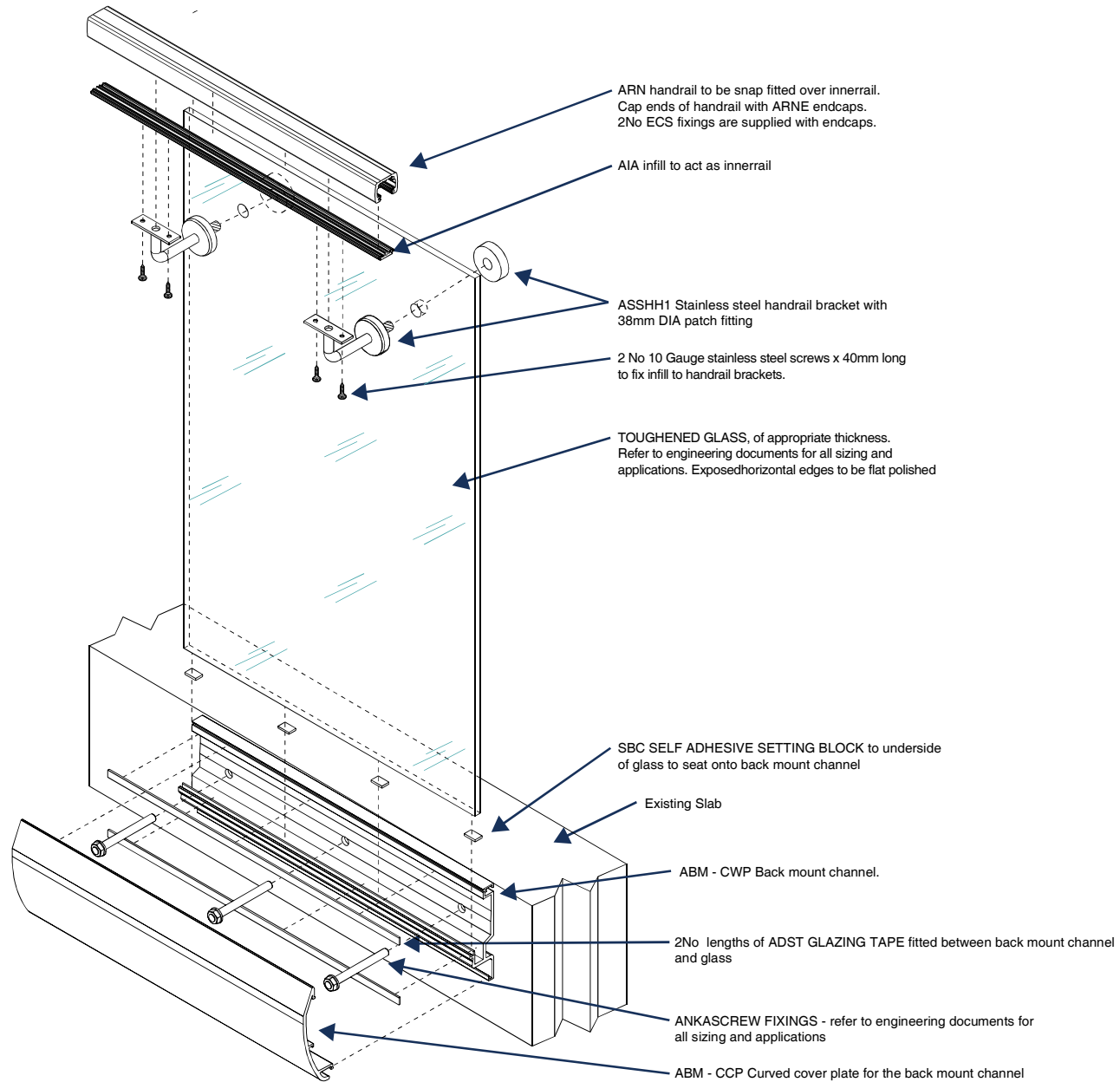

Paramount (SD14-05) Slab Edge Connection

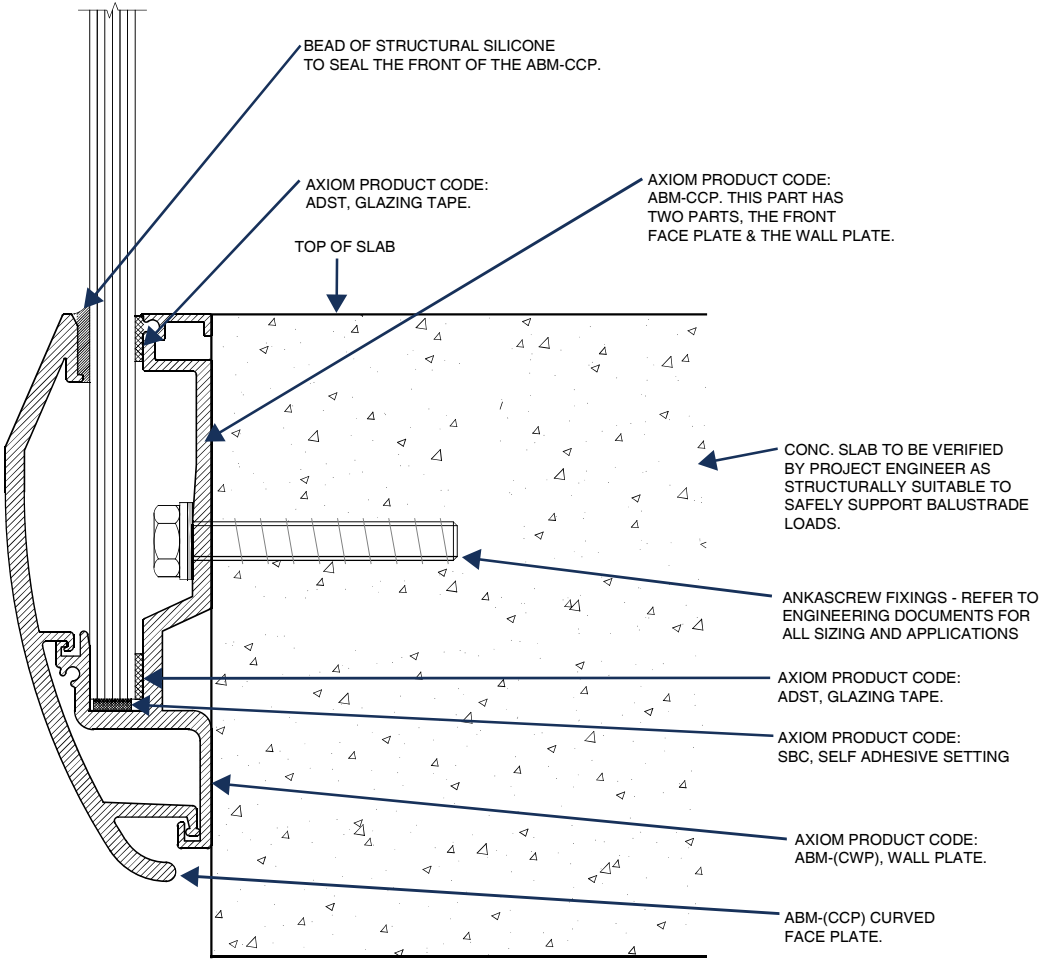

Paramount (SD14-06) Assembly

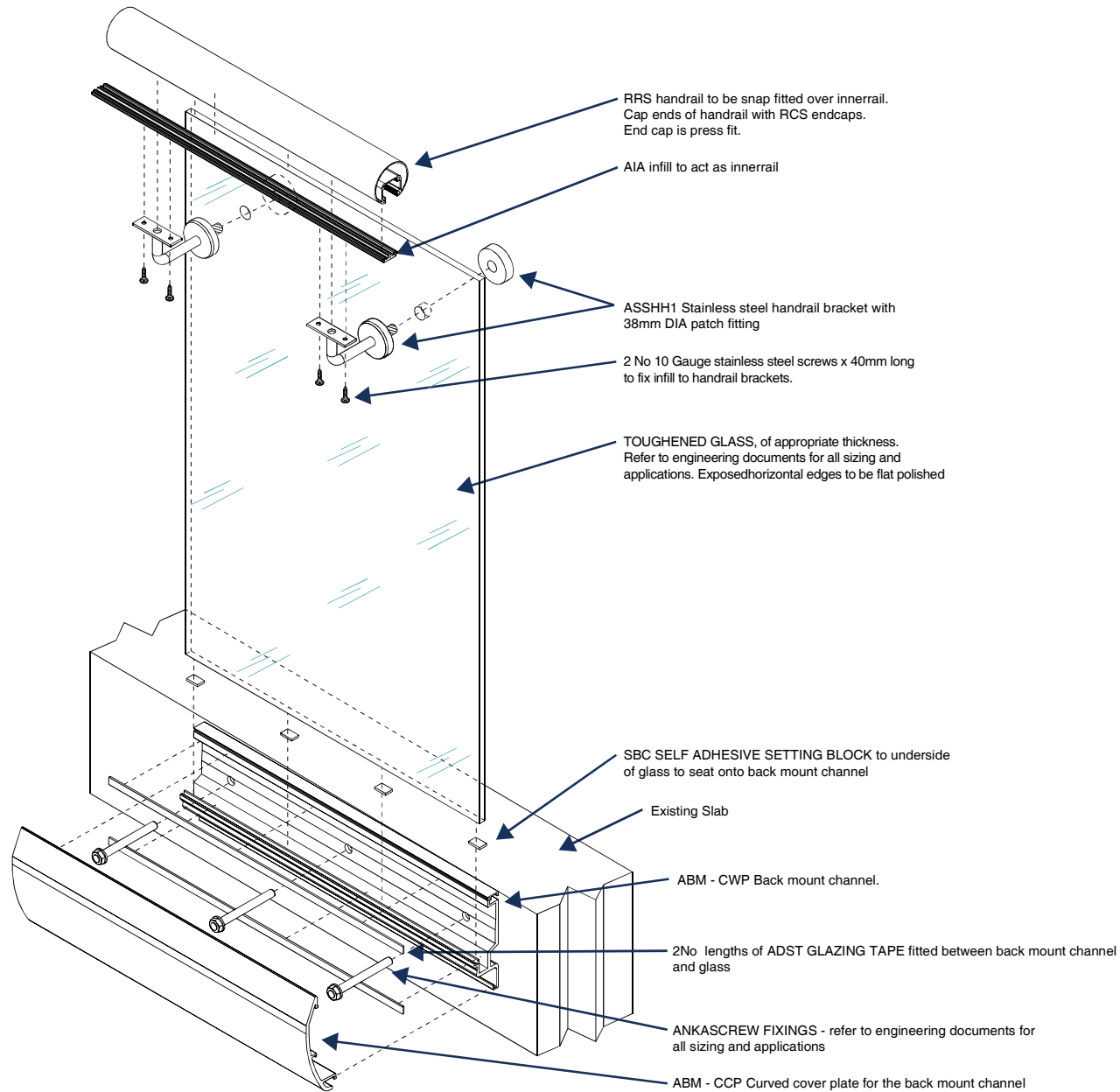

Paramount (SD14-06) Slab Edge Connection

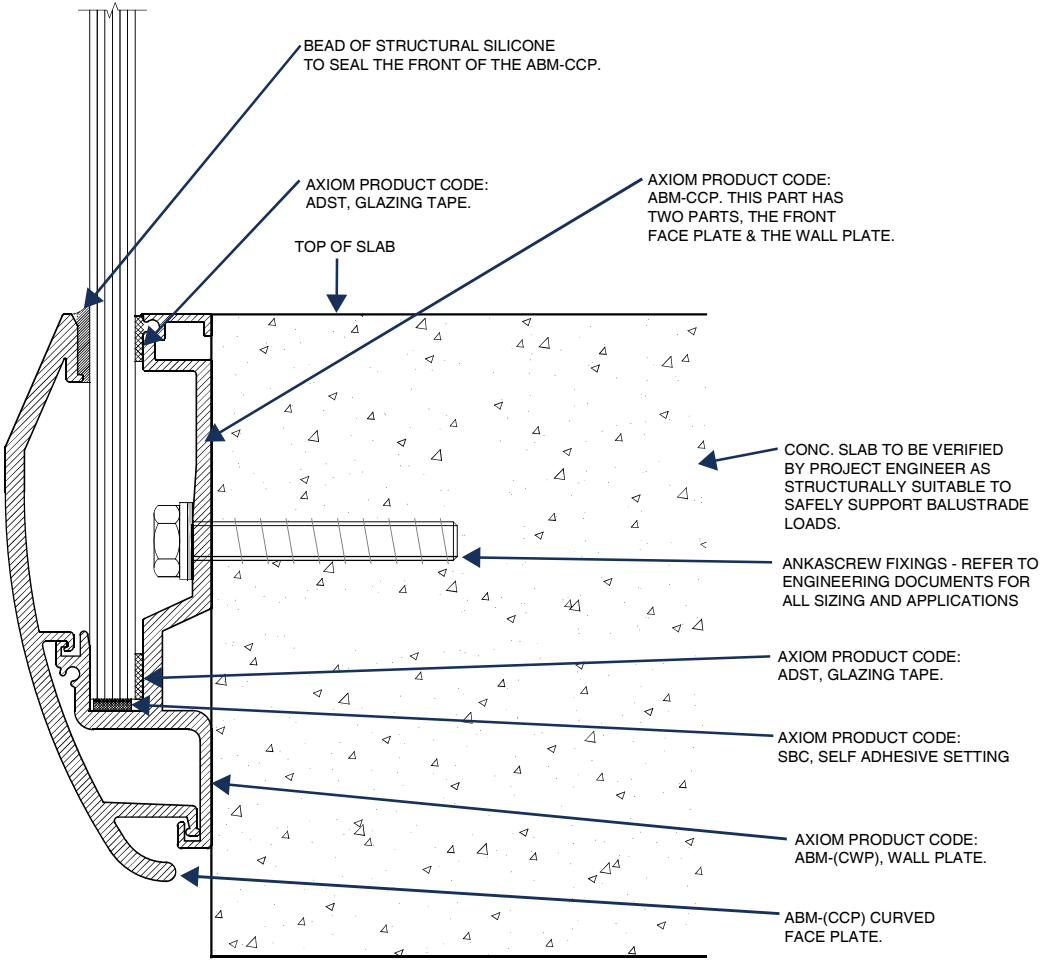

Paramount (SD14-11) Assembly

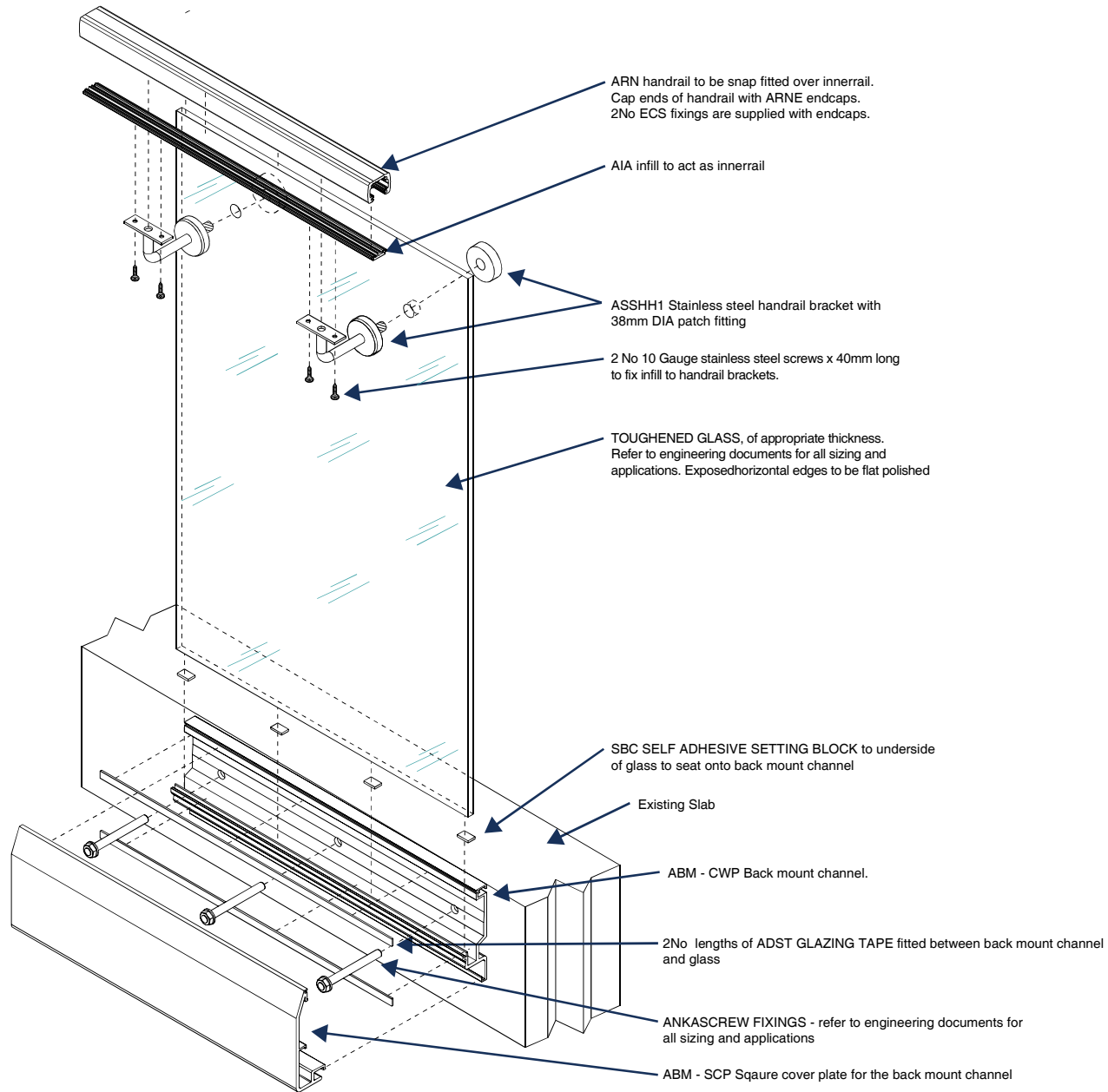

Paramount (SD14-11) Slab Edge Connection

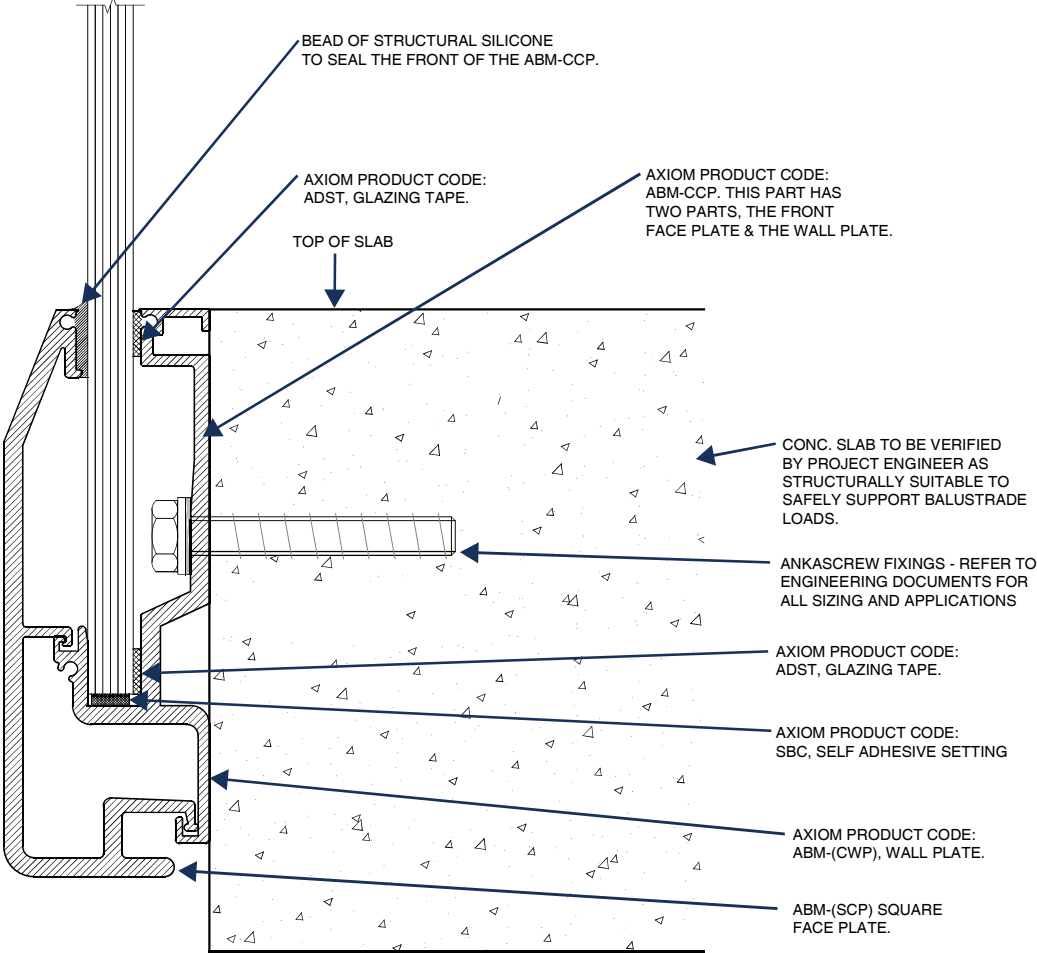

Paramount (SD14-12) Assembly

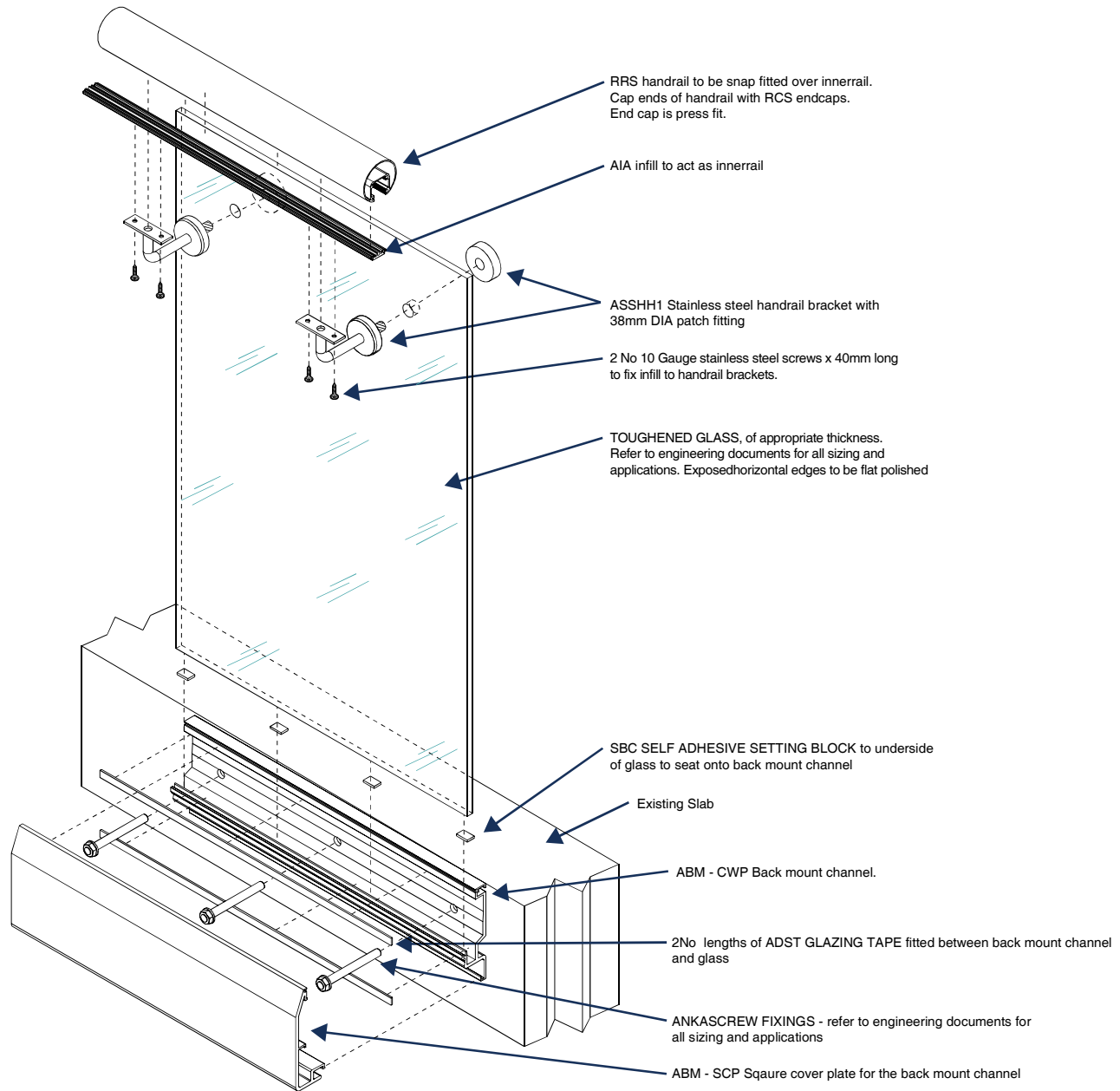

Paramount (SD14-12) Slab Edge Connection

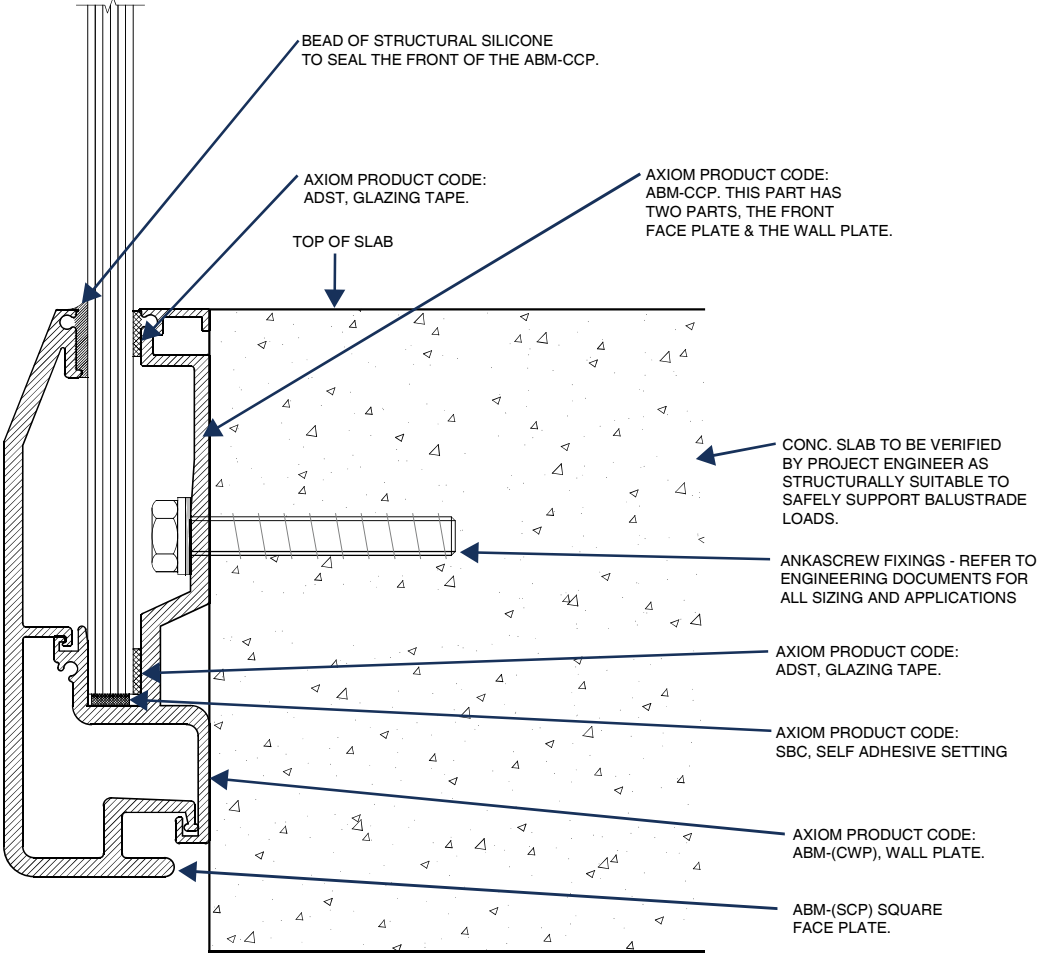

Paramount Handrail Bracket Connection

FIG 1. CONNECTION TO GLASS

2 No 10 gauge stainless steel screws to fix AIA infill to handrail bracket (Axiom Code: ASSHH1).
ASSHH1 handrail bracket attached to glass through 18mm DIA hole in glass with patch fitting.

